

**DATA**

DEVELOPED AREA - 106.0 ACRES (56%)  
(LOTS, ROADS, RIGHTS-OF-WAY, CLUB)

UNDEVELOPED AREA - 81.7 ACRES (44%)  
JURISDICTIONAL WETLANDS - 31.5 ACRES  
PARKS - 11.0 ACRES  
PONDS - 14.0 ACRES  
OTHER OPEN SPACES - 25.2 ACRES

TOTAL AREA - 187.7 ACRES

373 SINGLE FAMILY LOTS

**NOTES:**

- 1. BOUNDARY SURVEY IS FROM EMC ENGINEERING SERVICES, DATED 9/28/05
- 2. WETLANDS ARE EXTRACTED FROM A SEPARATE DRAWING, NOT FIELD SURVEYED.
- 3. ALL ACRES ARE MEASURED, BUT NOT FIELD VERIFIED.
- 4. PROPOSED ROAD RIGHTS-OF-WAY TO BE 60 FEET WIDE.

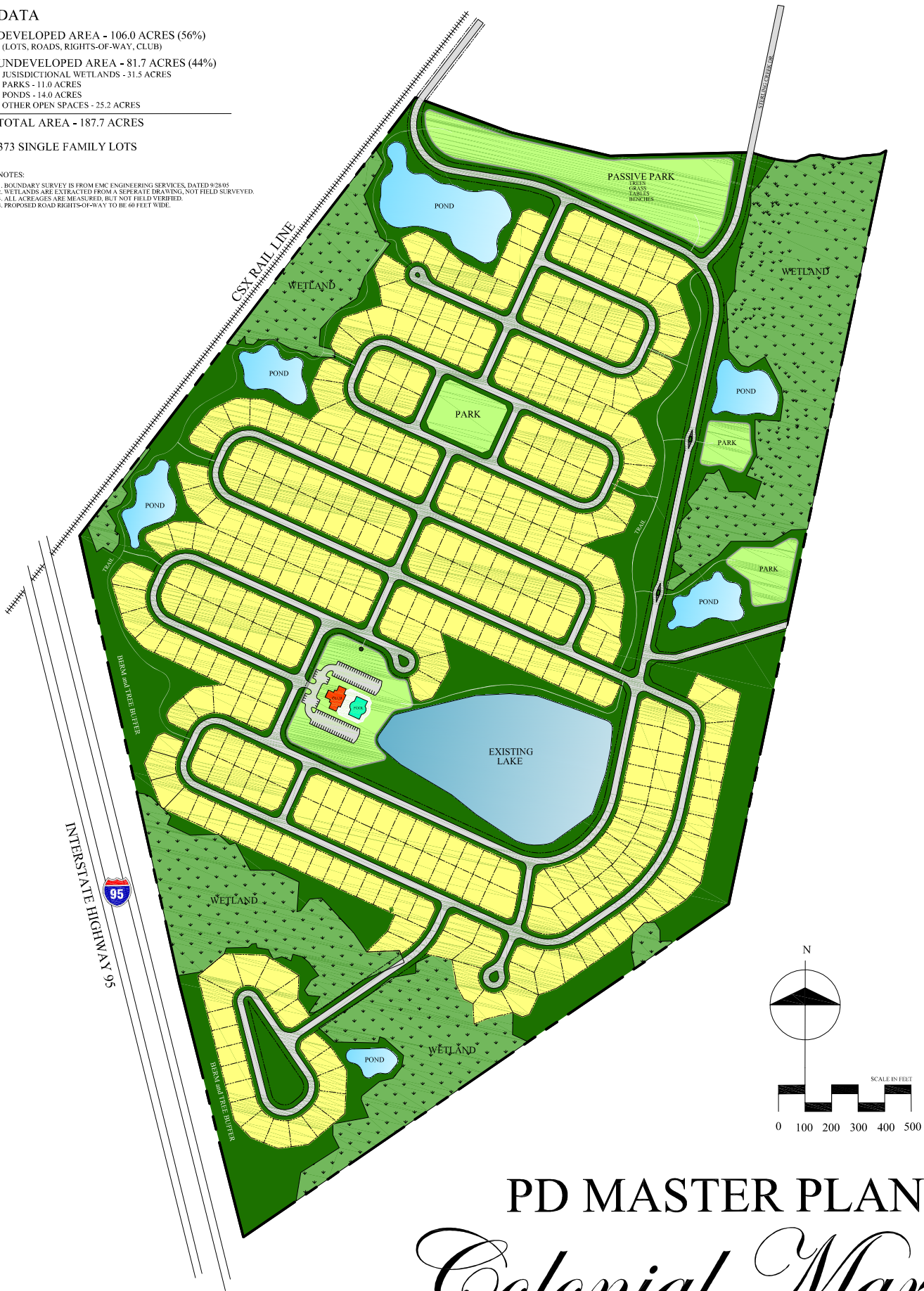

# PD MASTER PLAN

## *Colonial Marsh*